

A07 LOW PROFILE HIGH DENSITY IDC SOCKET

PITCH: 1.27mm * 2.54mm

SPECIFICATIONS

Material

Insulator : PBT, glass reinforced, rated UL 94V-0
 Contact : Phosphor Bronze

Electrical

Current Rating : 1 Amp
 Contact Resistance : 30 mΩ max.
 Insulation Resistance : 1000 MΩ min.
 Dielectric Withstanding Voltage : 250V AC for 1minute
 Operating Temperature : -40°C to +105°C

- ▶ Terminated with L03-0.635mm pitch flat ribbon cable.
- ▶ Mating Suggestion : C07, C07s & C08 series.

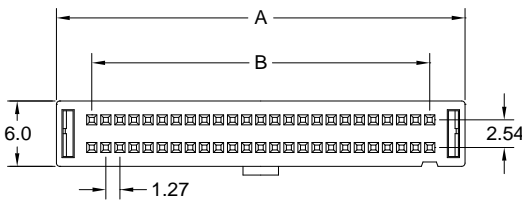

POSITION	A	B
10	11.45	5.08
14	13.99	7.62
16	15.26	8.89
20	17.80	11.43
26	21.61	15.24
30	24.15	17.78
34	26.69	20.32
40	30.50	24.13
50	36.85	30.48
60	43.20	36.83
68	48.28	41.91
70	49.55	43.18
80	55.90	49.53
90	62.25	55.88
100	68.60	62.23

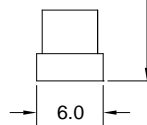
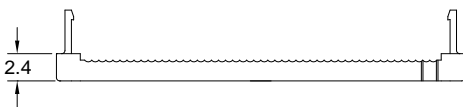
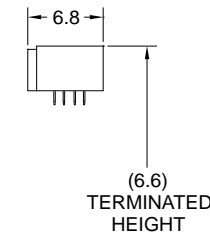
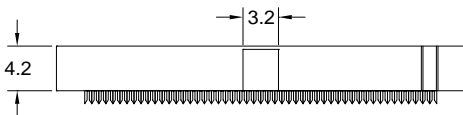

How to order: A07 - 1 - 2 - 3 - 4 - 5 - G(RoHS)

1.NO. OF CONTACT	2.CONTACT MATERIAL	3.CONTACT PLATING	4.SPECIAL FUNCTION	5.INSULATOR COLOR
10 14 16 20 26 30 34 40 50 60 68 70 80 90 100	B: PHOSPHOR BRONZE	T: TIN PLATED S: SELECTIVE G: GOLD FLASH A: 5u" INCH GOLD B: 10u" INCH GOLD C: 15u" INCH GOLD D: 30u" INCH GOLD	B: W/O STRAIN RELIEF W BAR	1. BLACK

