

# A15a HIGH DENSITY DIP PLUG

**PITCH: 1.27mm \* 1.9mm**

## SPECIFICATIONS

### Material

Insulator : PBT, glass reinforced, rated UL 94V-0  
 Contact : Phosphor Bronze

### Electrical

Current Rating : 1 Amp  
 Contact Resistance : 30 mΩ max.  
 Insulation Resistance : 1000 MΩ min.  
 Dielectric Withstanding Voltage : 250V AC for 1minute  
 Operating Temperature : -40°C to +105°C

► Terminated with L03-0.635mm pitch flat ribbon cable.

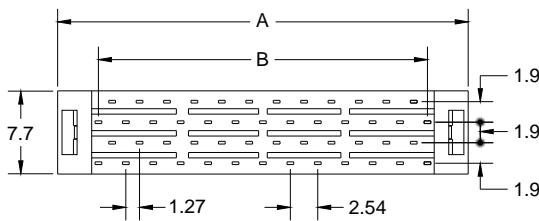

POSITION	A	B
10	12.63	5.08
14	15.17	7.62
16	16.44	8.89
20	18.98	11.43
26	22.79	15.24
30	25.33	17.78
34	27.87	20.32
40	31.68	24.13
50	38.03	30.48
60	44.38	36.83
68	49.46	41.91
80	57.08	49.53
100	69.78	62.23

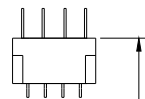
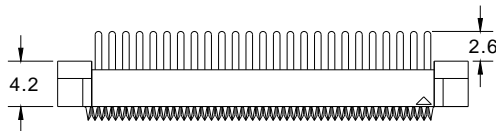

(6.9)  
TERMINATED  
HEIGHT

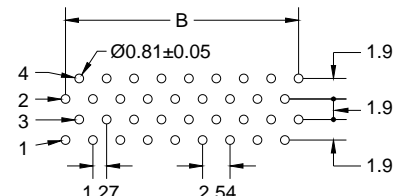
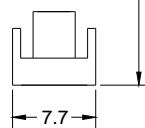
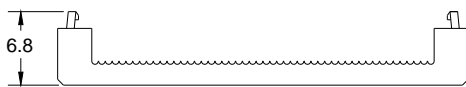

RECOMMENDED P.C.B. LAYOUT



**How to order:** A15a - 1 - 2 - 3 - 4 - G(RoHS)

1.NO. OF CONTACT	2.CONTACT MATERIAL	3.CONTACT PLATING	4.INSULATOR COLOR
10 14 16 20 26 30 34 40 50 60 68 80 100	B: PHOSPHOR BRONZE	<b>T: TIN PLATED</b> S: SELECTIVE G: GOLD FLASH A: 5u" INCH GOLD B: 10u" INCH GOLD C: 15u" INCH GOLD D: 30u" INCH GOLD	1. BLACK



**DON CONNEX**  
ELECTRONICS CO., LTD

T:886 2 86483356 | F:886 2 86485885  
e-mail: info@donconnex.com.tw



Connector:E163339 | Flat cable:E162690  
Wiring Harnesses:E312257