

A69a FINE PITCH BOX HEADER IDC TYPE

PITCH: 1.27mm * 2.54mm

SPECIFICATIONS

Material

Insulator : PBT, glass reinforced, rated UL 94V-0
Contact : Phosphor Bronze

Electrical

Current Rating : 1 Amp
Contact Resistance : 30 mΩ max.
Insulation Resistance : 1000 MΩ min.
Dielectric Withstanding Voltage : 250V AC for 1minute
Operating Temperature : -40°C to +105°C

- ▶ Terminated with L03-0.635mm pitch flat ribbon cable.
- ▶ Mating Suggestion: A07a,A62 & B15b series.

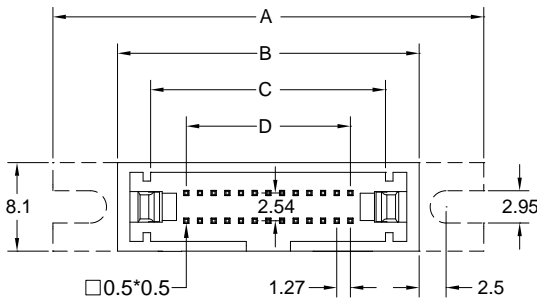
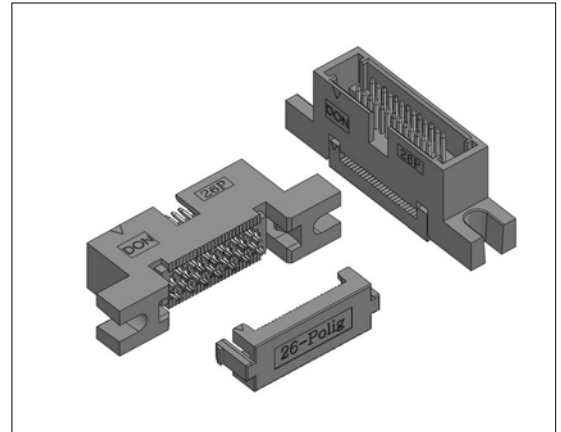

POSITION	A	B	C	D
10	29.85	17.85	11.65	5.08
14	32.39	20.39	14.19	7.62
16	33.66	21.66	15.46	8.89
20	36.20	24.20	18.00	11.43
26	40.01	28.01	21.81	15.24
30	42.55	30.55	24.35	17.78
34	45.09	33.09	26.89	20.32
40	48.90	36.90	30.70	24.13
50	55.25	43.25	37.05	30.48
60	61.60	49.60	43.40	36.83
68	66.68	54.68	48.48	41.91
70	67.95	55.95	49.75	43.18
80	74.30	62.30	56.10	49.53
90	80.65	68.65	62.45	55.88
100	87.00	75.00	68.80	62.23

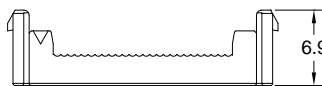
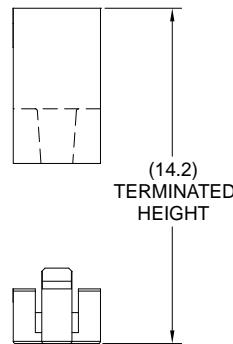
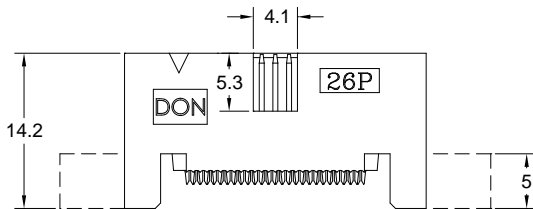

How to order: A69a - 1 - 2 - 3 - 4 - 5 - G(RoHS)

1.NO. OF CONTACT	2.CONTACT MATERIAL	3.CONTACT PLATING	4.SPECIAL FUNCTION	5.INSULATOR COLOR
10 14 16 20 26 30 34 40 50 60 68 70 80 90 100	B: PHOSPHOR BRONZE	T: TIN PLATED S: SELECTIVE G: GOLD FLASH A: 5u" INCH GOLD B: 10u" INCH GOLD C: 15u" INCH GOLD D: 30u" INCH GOLD	A: W MOUNTING EAR B: W/O MOUNTING EAR	1. BLACK