

A38c BOX HEADER IDC TYPE

PITCH: 2.0mm * 2.0mm

SPECIFICATIONS

Material

Insulator : PBT, glass reinforced, rated UL 94V-0
 Contact : Phosphor Bronze

Electrical

Current Rating : 1 Amp
 Contact Resistance : 30 mΩ max.
 Insulation Resistance : 3000 MΩ min.
 Dielectric Withstanding Voltage : 500V AC for 1minute
 Operating Temperature : -40°C to +105°C
 ▶ Terminated with L02-1.00mm pitch flat ribbon cable.
 ▶ Mating Suggestion : A05e & A58a series.

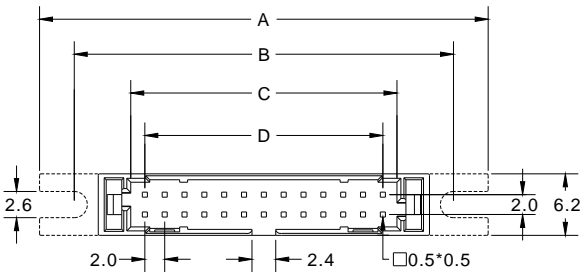
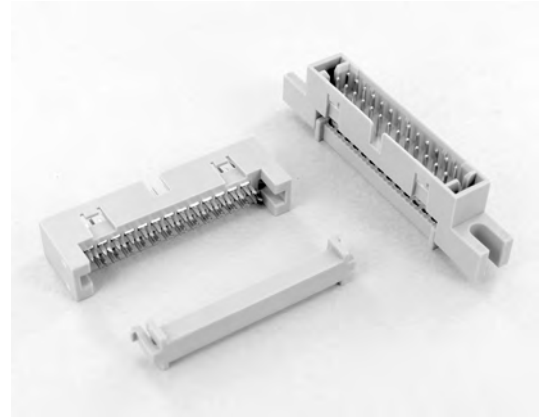

| POSITION | A | B | C | D | E |
|----------|-------|-------|-------|-------|-------|
| 10 | 29.24 | 22.24 | 10.84 | 8.00 | 17.40 |
| 12 | 31.24 | 24.24 | 12.84 | 10.00 | 19.40 |
| 14 | 33.24 | 26.24 | 14.84 | 12.00 | 21.40 |
| 16 | 35.24 | 28.24 | 16.84 | 14.00 | 23.40 |
| 20 | 39.24 | 32.24 | 20.84 | 18.00 | 27.40 |
| 22 | 41.24 | 34.24 | 22.84 | 20.00 | 29.40 |
| 24 | 43.24 | 36.24 | 24.84 | 22.00 | 31.40 |
| 26 | 45.24 | 38.24 | 26.84 | 24.00 | 33.40 |
| 30 | 49.24 | 42.24 | 30.84 | 28.00 | 37.40 |
| 34 | 53.24 | 46.24 | 34.84 | 32.00 | 41.40 |
| 40 | 59.24 | 52.24 | 40.84 | 38.00 | 47.40 |
| 44 | 63.24 | 56.24 | 44.84 | 42.00 | 51.40 |
| 50 | 69.24 | 62.24 | 50.84 | 48.00 | 57.40 |
| 68 | 87.24 | 80.24 | 68.84 | 66.00 | 75.40 |

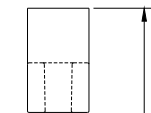
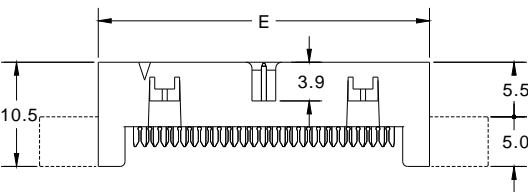

(10.5)
TERMINATED
HEIGHT

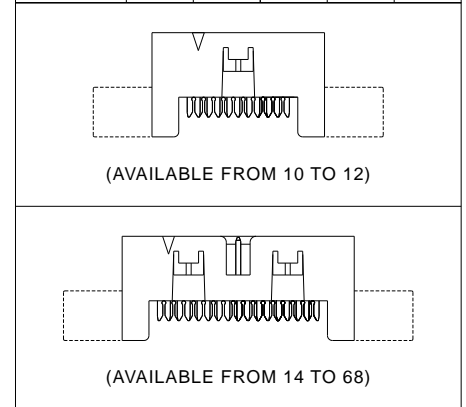
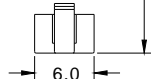
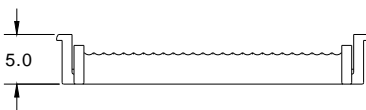

How to order: A38c - 1 - 2 - 3 - 4 - 5 - G(RoHS)

| 1.NO. OF CONTACT | 2.CONTACT MATERIAL | 3.CONTACT PLATING | 4.SPECIAL FUNCTION | 5.INSULATOR COLOR |
|---|--------------------|--|------------------------|-------------------|
| 10 12 14 16 20 22 24 26 30 34 40 44 50 68 | B: PHOSPHOR BRONZE | T: TIN PLATED S: SELECTIVE G: GOLD FLASH A: 5u" INCH GOLD B: 10u" INCH GOLD C: 15u" INCH GOLD D: 30u" INCH GOLD | A: W EAR B: W/O EAR | 2. GREY |

