

A66a WIRE TO BOARD CRIMP TERMINAL FOR A66

PITCH: 2.0mm

SPECIFICATIONS

Material

Contact : Phosphor Bronze

Electrical

- ▶ Wire Range : AWG#30 - 26
- Insulation O.D.: 1.4mm (max.)
- ▶ Crimp Housing mating : A66 series.

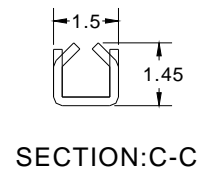
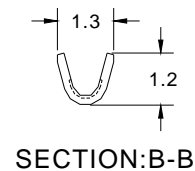
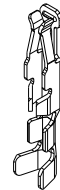
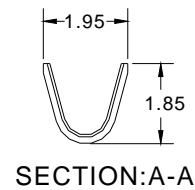
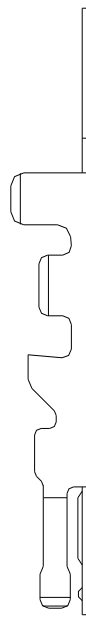
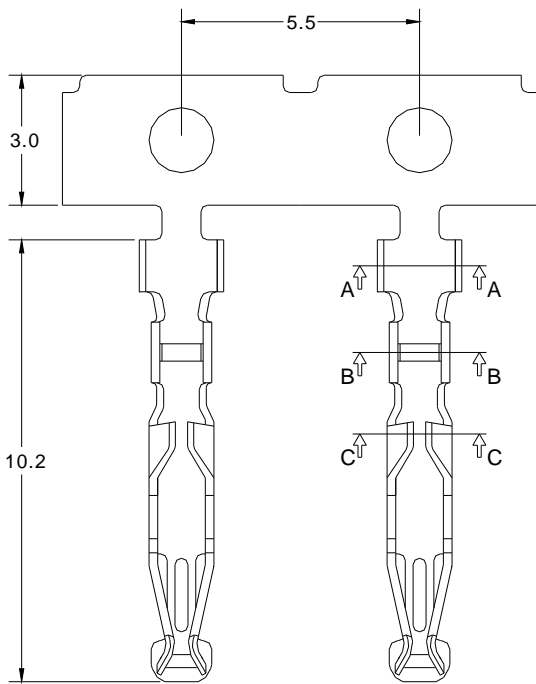
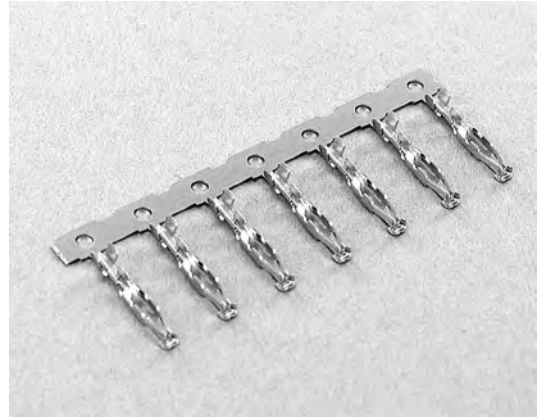

How to order: A66a - 1 - 2 - G(RoHS)

1.CONTACT MATERIAL	2.CONTACT PLATING
B: PHOSPHOR BRONZE	T: TIN PLATED S: SELECTIVE G: GOLD FLASH A: 5u" INCH GOLD B: 10u" INCH GOLD C: 15u" INCH GOLD D: 30u" INCH GOLD