

A40a CRIMP TERMINAL FOR A40 2.54mm

PITCH: 2.54mm

SPECIFICATIONS

Material

Contact : Phosphor Bronze

▶ Wire Range : AWG#28 - 24

Insulation O.D. : 0.8 - 1.5mm

▶ Crimp Housing mating : A40 & A40b series

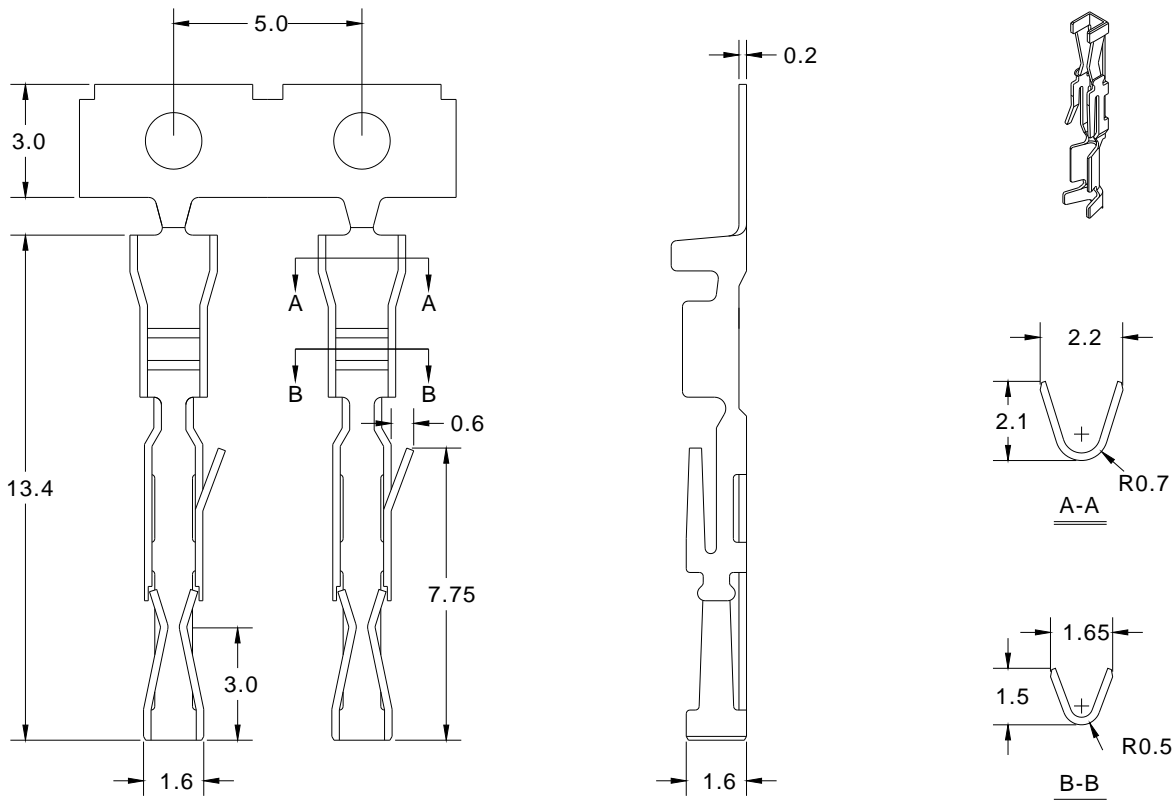
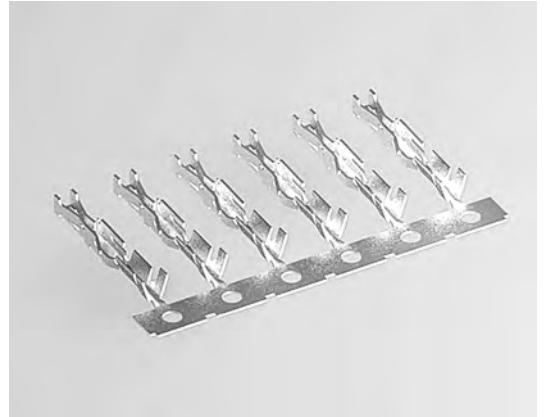

How to order: A40a - 1 - 2 - G(RoHS)

1.CONTACT MATERIAL	2.CONTACT PLATING
B: PHOSPHOR BRONZE	T: TIN PLATED S: SELECTIVE G: GOLD FLASH A: 5u" INCH GOLD B: 10u" INCH GOLD C: 15u" INCH GOLD D: 30u" INCH GOLD