

A13 DIP PLUG (.1"*.3")

PITCH: 2.54mm * 7.62mm

SPECIFICATIONS

Material

Insulator : PBT, glass reinforced, rated UL 94V-0
 Contact : Phosphor Bronze

Electrical

Current Rating : 1 Amp
 Contact Resistance : 30 mΩ max.
 Insulation Resistance : 3000 MΩ min.
 Dielectric Withstanding Voltage : 500V AC for 1minute
 Operating Temperature : -40°C to +105°C
 ▶ Terminated with L01-1.27mm pitch flat ribbon cable.

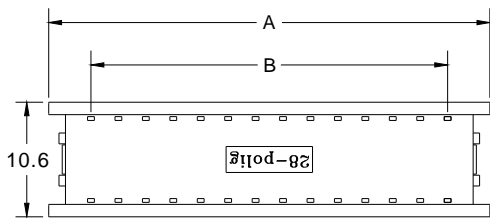
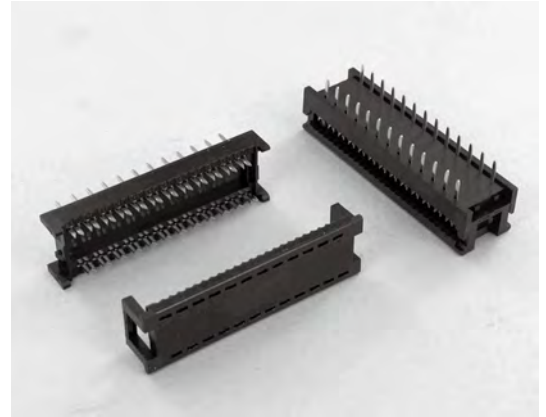

POSITION	A	B
8	15.44	7.62
10	17.98	10.16
14	23.06	15.24
16	25.60	17.78
18	28.14	20.32
20	30.68	22.86
24	35.76	27.94
26	33.22	25.40
28	40.84	33.02
34	48.46	40.64
40	56.08	48.26

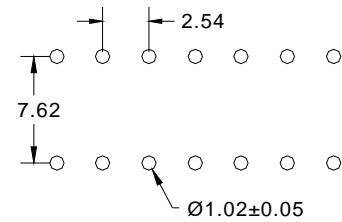
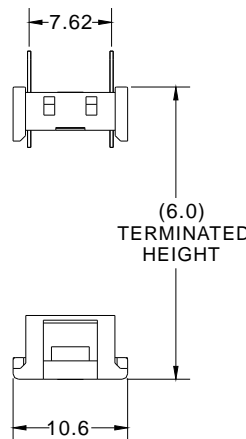
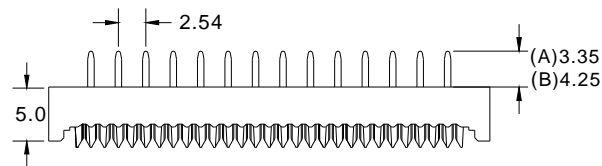

RECOMMENDED P.C.B. LAYOUT

How to order: A13 - 1 - 2 - 3 - 4 - 5 - G(RoHS)

1.NO. OF CONTACT	2.CONTACT MATERIAL	3.CONTACT PLATING	4.PIN LENGTH	5.INSULATOR COLOR
08 10 14 16 18 20 24 26 28 34 40	B: PHOSPHOR BRONZE	T: TIN PLATED S: SELECTIVE G: GOLD FLASH A: 5u" INCH GOLD B: 10u" INCH GOLD C: 15u" INCH GOLD D: 30u" INCH GOLD	A: 3.35mm B: 4.25mm	1. BLACK 2. GREY