

A72 SLENDER IDC SOCKET CLOSE END TYPE

PITCH: 2.54mm * 2.54mm

SPECIFICATIONS

Material

Insulator : PBT, glass reinforced, rated UL 94V-0
 Contact : Phosphor Bronze

Electrical

Current Rating : 1 Amp
 Contact Resistance : 30 mΩ max.
 Insulation Resistance : 3000 MΩ min.
 Dielectric Withstanding Voltage : 500V AC for 1minute
 Operating Temperature : -40°C to +105°C

- ▶ Terminated with L01-1.27mm pitch flat ribbon cable.
- ▶ Mating Suggestion : C105, C105a & C105b series.

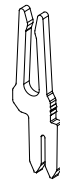
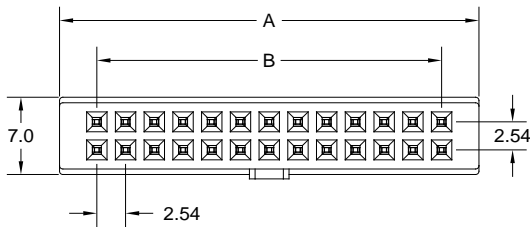

POSITION	A	B	C
4	9.14	2.54	1.85
6	11.68	5.08	1.85
8	14.22	7.62	1.85
10	16.76	10.16	3.5
12	19.30	12.70	3.5
14	21.84	15.24	3.5
16	24.38	17.78	3.5
20	29.46	22.86	3.5
24	34.54	27.94	3.5
26	37.08	30.48	3.5
30	42.16	35.56	3.5
34	47.24	40.64	3.5
40	54.86	48.26	3.5

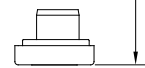
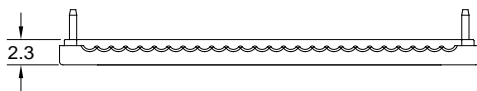
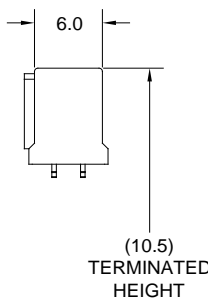
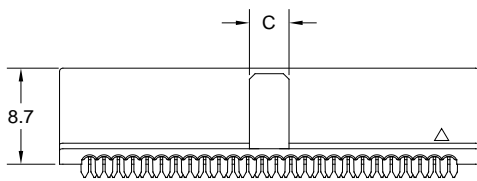

How to order: A72 - 1 - 2 - 3 - 4 - 5 - G(RoHS)

1.NO. OF CONTACT	2.CONTACT MATERIAL	3.CONTACT PLATING	4.SPECIAL FUNCTION	5.INSULATOR COLOR
04 06 08 10 12 14 16 20 24 26 30 34 40	B: PHOSPHOR BRONZE	T: TIN PLATED S: SELECTIVE G: GOLD FLASH A: 5u" INCH GOLD B: 10u" INCH GOLD C: 15u" INCH GOLD D: 30u" INCH GOLD	B: W/O STRAIN RELIEF W BAR D: W/O STRAIN RELIEF W/O BAR	1. BLACK

