

B19 SINGLE ROW SHROUDED HEADER WITH POLARIZATION

PITCH: 2.54mm

SPECIFICATIONS

Material

Insulator : PBT, glass reinforced, rated UL 94V-0

Contact : Brass

Electrical

Current Rating : 1 Amp

Contact Resistance : 30 mΩ max.

Insulation Resistance : 3000 MΩ min.

Dielectric Withstanding Voltage : 500V AC for 1minute

Operating Temperature : -40°C to +105°C

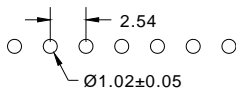
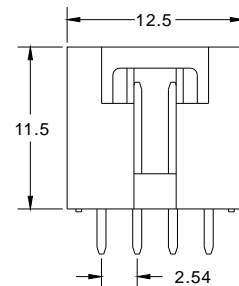
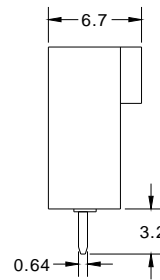
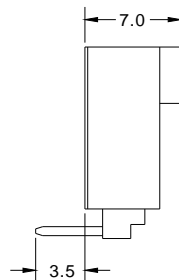
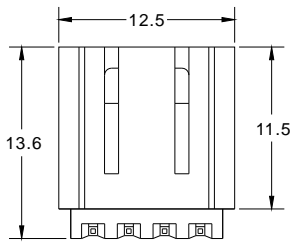
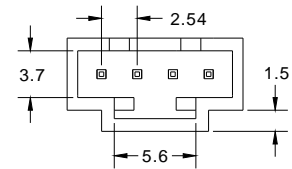
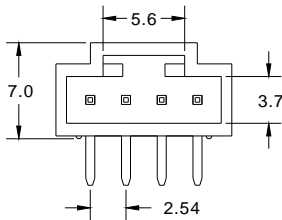
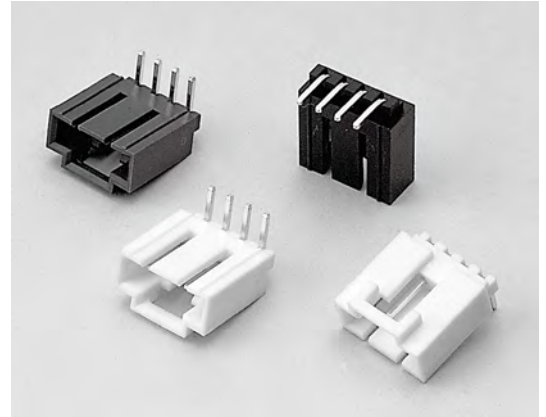

RECOMMENDED P.C.B LAYOUT

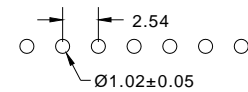

RECOMMENDED P.C.B LAYOUT

How to order: B19 - 1 - 2 - 3 - 4 - 5 - G(RoHS)

1.NO. OF CONTACT	2.CONTACT MATERIAL	3.CONTACT PLATING	4.MOUNTING TYPE	5.INSULATOR COLOR
02 03 04 05 06 07 08 09 10 11 12	A: BRASS	T: TIN PLATED S: SELECTIVE G: GOLD FLASH A: 5u" INCH GOLD B: 10u" INCH GOLD C: 15u" INCH GOLD D: 30u" INCH GOLD	S: STRAIGHT R: RIGHT ANGLE	1. BLACK

